

# DETOUR PLAN

## Detour Plan CT-TGS-2023-8033

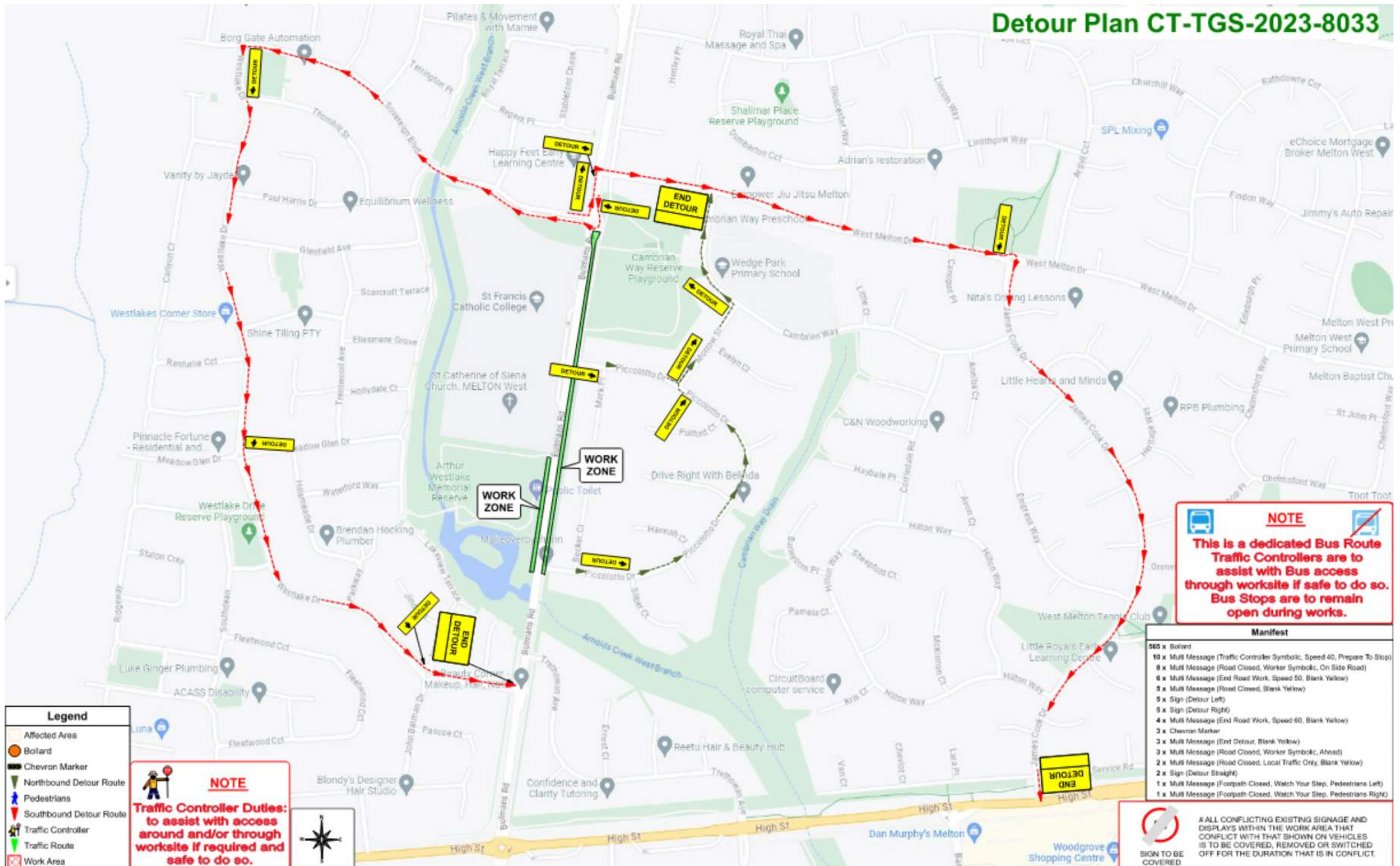

**NOTE**  
 This is a dedicated Bus Route. Traffic Controllers are to assist with Bus access through worksite if safe to do so. Bus Stops are to remain open during works.

- Legend**
- Affected Area
  - Bollard
  - Chevron Marker
  - Northbound Detour Route
  - Pedestrians
  - Southbound Detour Route
  - Traffic Controller
  - Traffic Route
  - Work Area

**NOTE**  
 Traffic Controller Duties: to assist with access around and/or through worksite if required and safe to do so.



**Manifest**

500 x	Bollard
10 x	Multi Message (Traffic Controller Symbolic, Speed 40, Prepare To Stop)
9 x	Multi Message (Road Closed, Worker Symbolic, On Side Road)
6 x	Multi Message (End Road Work, Speed 50, Blank Yellow)
5 x	Multi Message (Road Closed, Blank Yellow)
5 x	Sign (Detour Left)
5 x	Sign (Detour Right)
4 x	Multi Message (End Road Work, Speed 60, Blank Yellow)
3 x	Chevron Marker
3 x	Multi Message (End Detour, Blank Yellow)
3 x	Multi Message (Road Closed, Worker Symbolic, Ahead)
2 x	Multi Message (Road Closed, Local Traffic Only, Blank Yellow)
2 x	Sign (Detour Straight)
1 x	Multi Message (Footpath Closed, Watch Your Step, Pedestrians Left)
1 x	Multi Message (Footpath Closed, Watch Your Step, Pedestrians Right)

**NOTE**  
 ALL CONFLICTING EXISTING SIGNAGE AND DISPLAYS WITHIN THE WORK AREA THAT CONFLICT WITH THAT SHOWN ON THIS PLAN IS TO BE COVERED, REMOVED OR SWITCHED OFF FOR THE DURATION THAT IS IN CONFLICT.